

ZMSM Series with Mounting Hole Subminiature Snap-acting Switches (IP65)

Features/Benefits

- Reliable snap-acting mechanism
- Long electrical and mechanical life
- Various PCB terminals and actuators
- RoHS compatible
- IP67 with potted wires only

Typical Applications

- Communication devices
- Testing equipment
- Security/Alarm systems

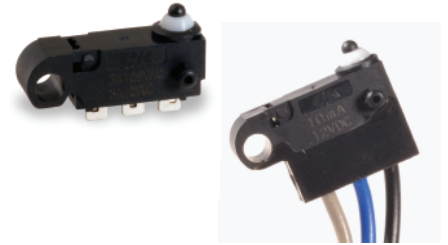

UL61058-1  US

Specifications

CONTACT RATING: 3A@ 125 V AC/ 3A@ 12 V DC, 0.01 A@ 12 V DC.

ELECTRICAL LIFE: 100,000 cycles @ 0.01 A, 12 V DC / 100,000 cycles @ 3A, 12 V DC, 6,000 cycles @ 3A, 125 VAC

INSULATION RESISTANCE: 100 M ohm min.

DIELECTRIC STRENGTH: 500 Vrms.

OPERATING TEMPERATURE: see chart below.

OPERATING FORCE: 130 grams.

* Low Level=conditions where no arcing occurs during switching, i.e., 0.4 VA max. @ 20 V AC or DC max.

Materials

CASE: Nylon

COVER/ACTUATOR: PBT

MOVABLE CONTACTS: 3 Amp silver, 0.01A gold

STATIONARY CONTACTS: 3 Amp silver, 0.01A gold

TERMINALS: Brass, Pre-plated with silver

LEVER: Stainless steel

NOTE: Specifications and materials listed above are for switches with standard options. For information on specific and custom switches, consult Customer Service Center.

Build-A-Switch

To order, simply select desired option from each category and place in the appropriate box. Available options are shown and described on pages J-62 through J-64. For additional options not shown in catalog, consult Customer Service Center.

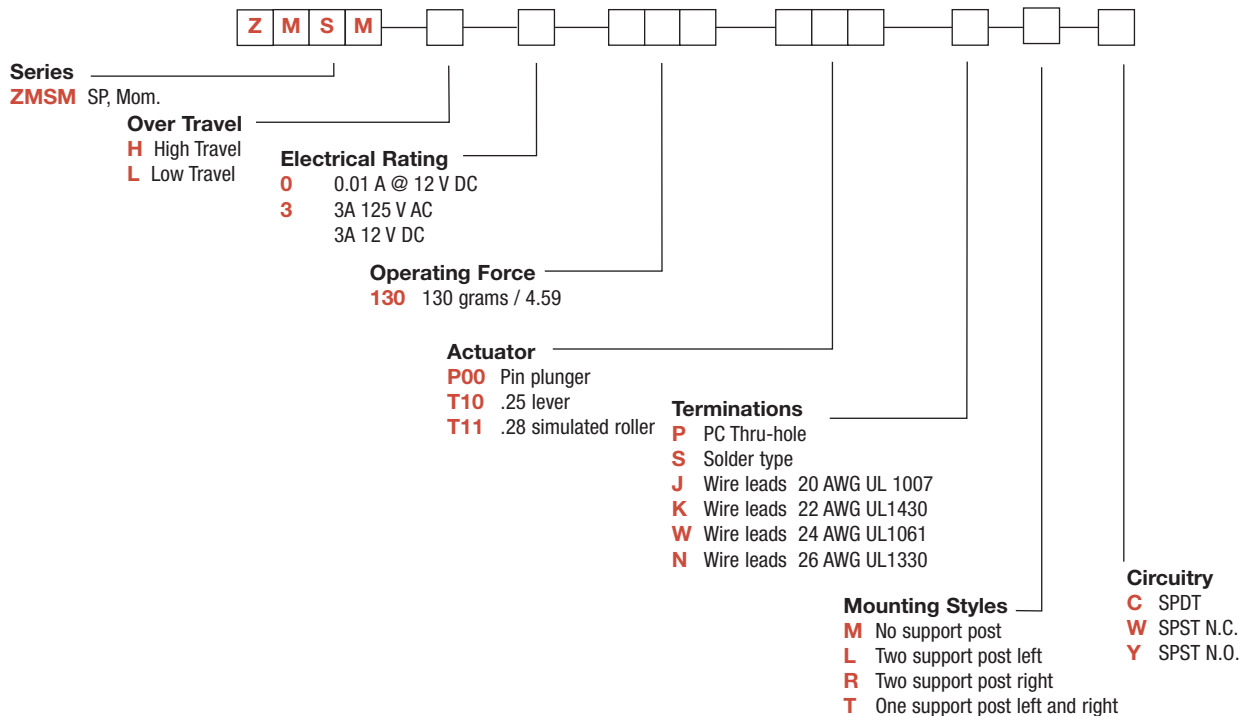

Dimensions are shown: mm
 Specifications and dimensions subject to change



Snap-acting

ZMSM Series with Mounting Hole Subminiature Snap-acting Switches (IP65)

SERIES

ZMSMH HIGH OVER TRAVEL

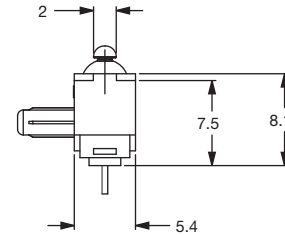
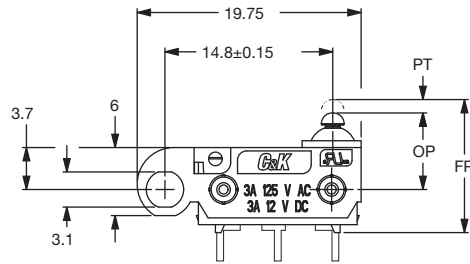
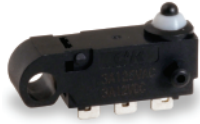

ZMSML LOW OVER TRAVEL

MODEL SHOWN: ZMSMHXXXP00PLC

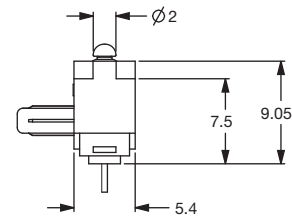
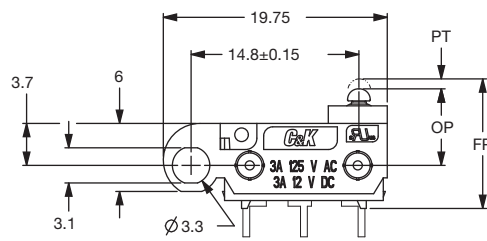

MODEL SHOWN: ZMSMLXXXP00PLC



Snap-acting

ELECTRICAL RATING

| OPTION CODE | RoHS COMPLIANT* | RoHS COMPATIBLE* | CONTACT MATERIAL | | ELECTRICAL RATING |
|-------------|-----------------|------------------|------------------|--------------------|---------------------------------------|
| | | | MOVABLE CONTACT | STATIONARY CONTACT | |
| 0 | Yes | Yes | Gold alloy | | 0.01 A @ 12 V DC |
| 3 | Yes | Yes | Silver alloy | | 3 AMPS @ 125 V AC 3 AMPS @ 12 V DC |

Model **C&K** **US** with option "S" (solder type) only.
Consult Customer Service center for availability and delivery of nonstandard ratings.

OPERATING FORCE

| OPTION CODE | BASIC SWITCH OPERATING FORCE (OZ./GRAMS) |
|-------------|--|
| 130 | 130 4.59 |



Dimensions are shown: mm
Specifications and dimensions subject to change



ZMSM Series with Mounting Hole Subminiature Snap-acting Switches (IP65)

ACTUATOR

P00 PIN PLUNGER (IP65)

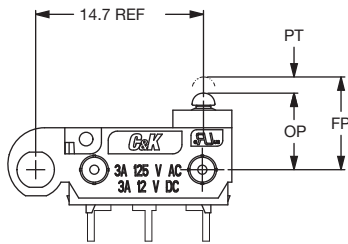

MODEL SHOWN: ZMSMLXXXXP00PLC

T10 .25 LEVER (IP65)

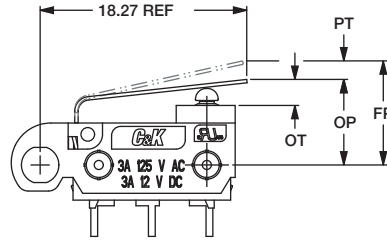

MODEL SHOWN: ZMSMLXXXT10PLC

T11 LEVER (IP65)

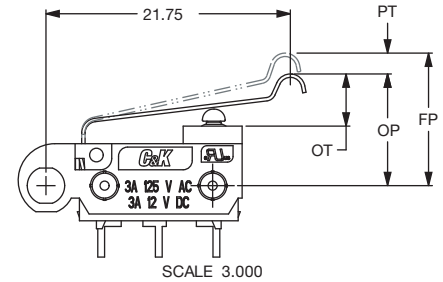

MODEL SHOWN: ZMSMLXXXT11PLC

SWITCH CHARACTERISTICS

| Actuator code | Maximum Operate Force (grams/oz.) | Minimum Release Force (grams/oz.) | Free Position Max (mm) | Maximum Pre-travel (mm) | Operate Position (mm) | Maximum Differential (mm) | Low Overtravel min. (mm) | High Overtravel min. (mm) |
|---------------|-----------------------------------|-----------------------------------|------------------------|-------------------------|-----------------------|---------------------------|--------------------------|---------------------------|
| P00 | 130 4.59 | 13 0.45 | 7.35 | 0.8 | 6.75 ± 0.3 | 0.3 | 0.8 | 1.75 |
| T10 | 195 6.88 | 55 1.93 | 10.70 | 3.85 | 7.40 ± 0.8 | 0.5 | 1.35 | 2.3 |
| T11 | 160 5.64 | 45 1.58 | 13.80 | 4.8 | 9.90 ± 0.8 | 0.7 | 1.65 | 2.6 |

TERMINATIONS

P PC THRU-HOLE (IP65)

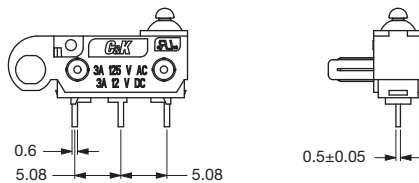

MODEL SHOWN: ZMSMHXXXXP00PLC

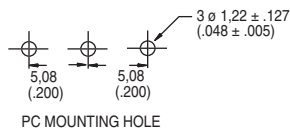

PC MOUNTING HOLE

S SOLDER TYPE (IP65)

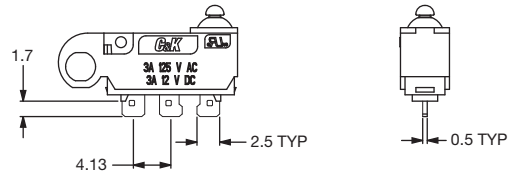

MODEL SHOWN: ZMSMHXXXXP00SMC

J WIRE LEADS BOTTOM (IP67)

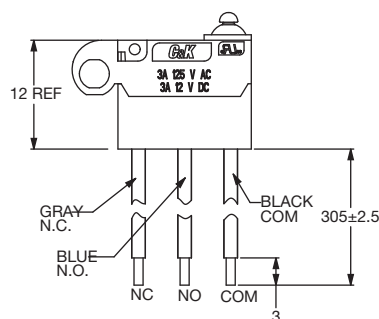

Standard Wire: 20 AWG UL 1007

Available options - must specify

22AWG UL1430

24AWG UL1061

26AWG UL1330



Third Angle Projection

Dimensions are shown: mm
Specifications and dimensions subject to change



ZMSM Series with Mounting Hole Subminiature Snap-acting Switches (IP65)

MOUNTING STYLES

M NO SUPPORT POSTS

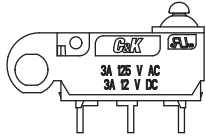
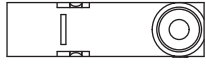

MODEL SHOWN:
ZMSMHXXXXP00PMC

L TWO SUPPORT POSTS LEFT

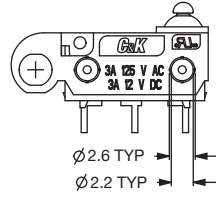
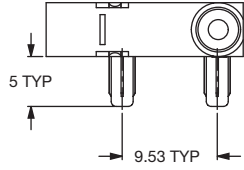

POSTS LEFT
MODEL SHOWN:
ZMSMHXXXXP00PLC

R TWO SUPPORT POSTS RIGHT

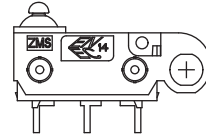
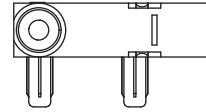

POSTS RIGHT
MODEL SHOWN:
ZMSMHXXXXP00PRC

T ONE SUPPORT POST
LEFT & RIGHT

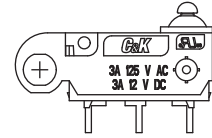
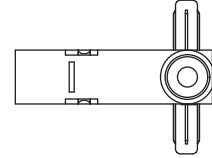

LEFT & RIGHT
MODEL SHOWN:
ZMSMHXXXXP00PTC



Snap-acting

CIRCUITRY

- C** SPDT (Single Pole, Double Throw)
- W** SPST, NC (Single Pole, Single Throw, Normally Closed)
- Y** SPST, NO (Single Pole, Single Throw, Normally Open)

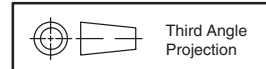

Dimensions are shown: mm
Specifications and dimensions subject to change

