

RECOMMENDED PCB LAYOUT

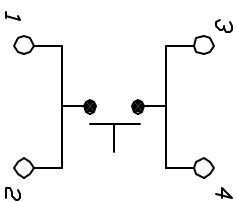
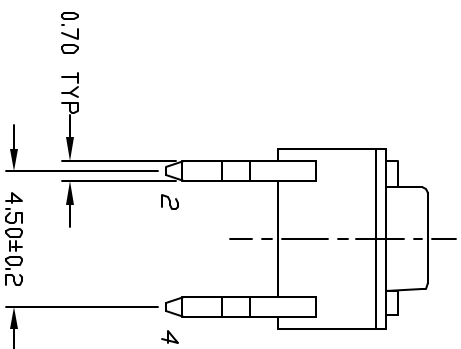
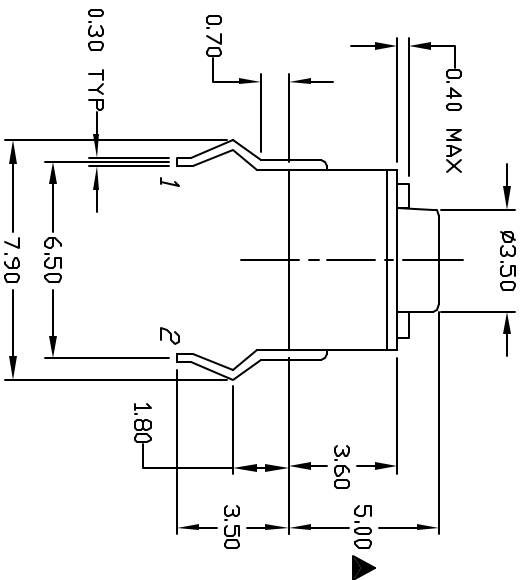

CIRCUIT: SPST  
CONTACT CONFIGURATION

- NOTES:
1. ALL DIMENSIONS IN MM
  2. GENERAL TOLERANCE: 0.0 ± 0.4  
0.00 ± 0.25
  3. TERM. NOS. FOR REF. ONLY
  4. RATING: 50mA, @12V DC
  5. TRAVEL: 0.25 ± 0.1mm
  6. OPERATING FORCE: 250 ± 50gf
  7. CONTACT RESISTANCE: 100m ohms max.
  8. ELECTRICAL LIFE: 100,000 CYCLES MIN.
  9. INSULATION RESISTANCE: 100M ohms min.
  10. DIELECTRIC STRENGTH: 250V RMS MIN.
  11. OPERATING TEMP.: -30°C to +85°C
  12. ▲ DESIGNATE MAJOR DIMENSIONS

**E-SWITCH**

TL 1105A F250 Q

REV.	10682	REVISION & DRAWN	6/14/00	MM
ECN NO.		DESCRIPTION	DATE	CHKD
THE INFORMATION CONTAINED IN THIS DOCUMENT IS PROPRIETARY TO E-SWITCH AND IS NOT TO BE COPIED OR TRANSMITTED				

TITLE	SCALE	DATE	DR	DWG	REV
TL 1105A F250 Q	4:1	8/14/96	MM	P010012	C