

Mating connector: 50-00009

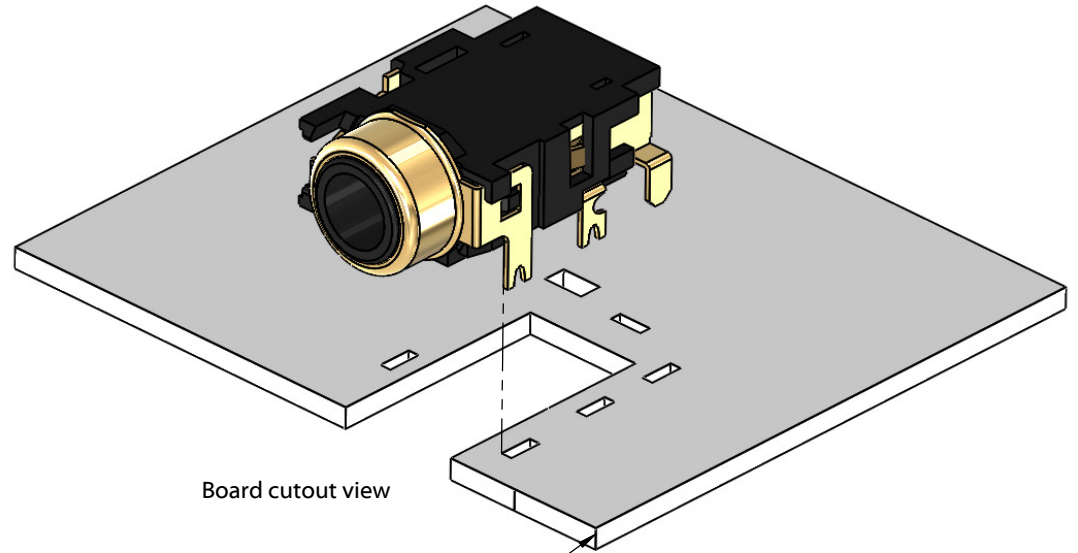

Board cutout view

Recommended board thickness: 1.1-1.6 mm

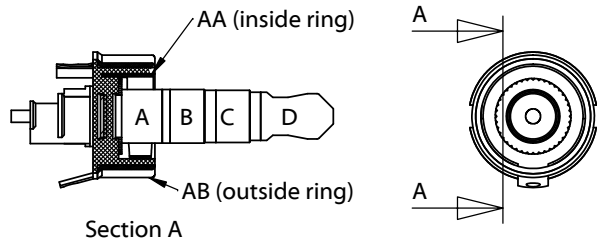
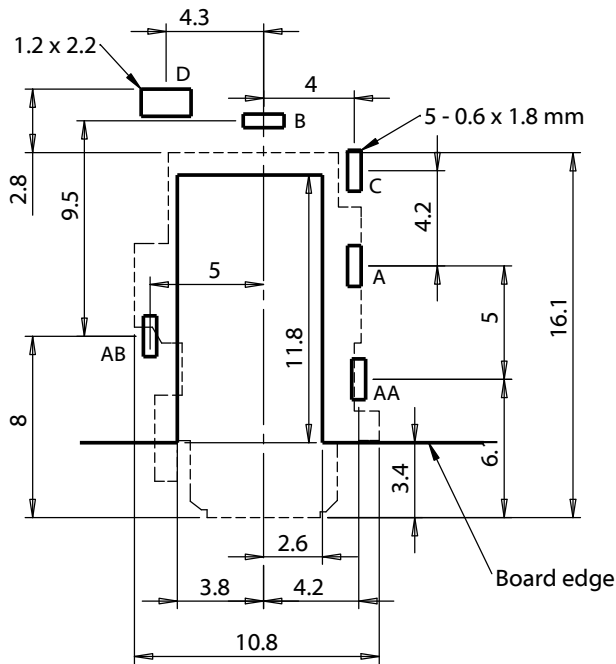

PCB Layout

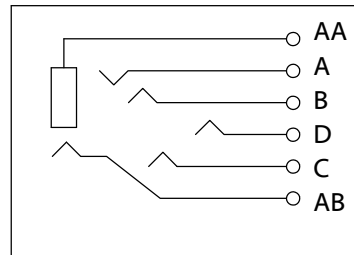

Schematic

Revision:	Date:	Description:	Prepared:	Notes:	<h1>TENSILITY</h1> <p>tel 1.541.323.3228 800 877.670.7118 fax 1.541.323.4202 web tensility.com</p>				
A	2/11/2015	Initial release		RoHS and REACH compliant					
A1	11/5/2015	added wiring schematic, updated description	Verified:	Function test: no open, no short circuit, no intermittent	<table border="1"> <tr> <td>Size:</td> <td>Part number:</td> </tr> <tr> <td>A</td> <td>54-00032</td> </tr> </table>	Size:	Part number:	A	54-00032
Size:	Part number:								
A	54-00032								
A2	7/12/2016	Corrected PCB Layout	Dimensions are in millimeters. Tolerances: X: ± 0.5 mm X.X: ± 0.3 mm X.XX: ± 0.05 mm	Description: Connector, 3.5xL21.3 mm, 6C audio plug with double metal rings, brass gold plated	Scale: 3:1				
A3	4/25/2017	Modified PCB dimensioning				Sheet 2 of 2			