

SECTION A-A
TYP

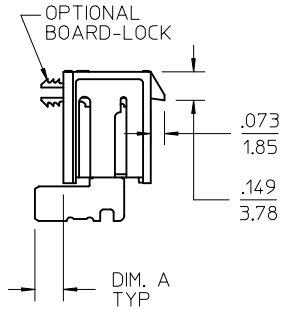

SIDE VIEW, TYP

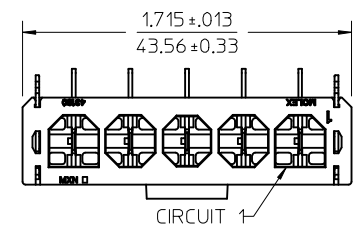
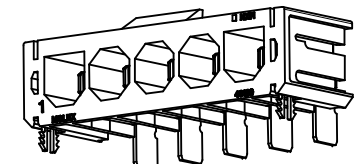
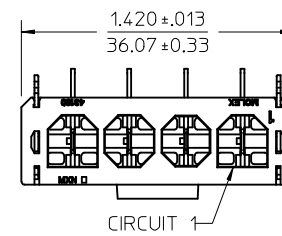
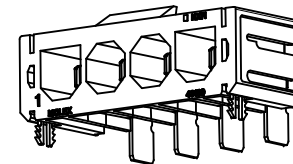
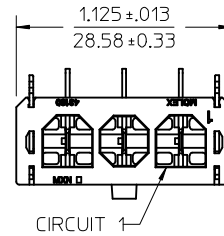
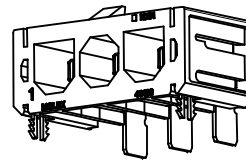
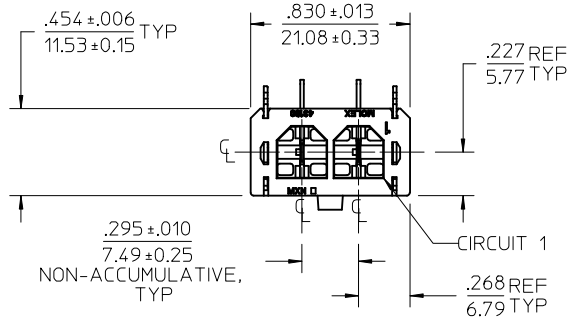
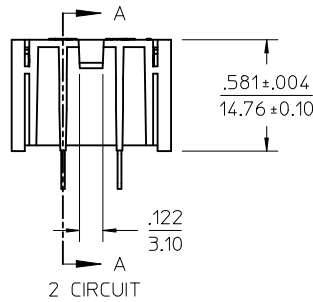

2 CIRCUIT

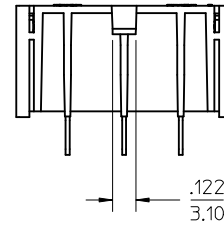

3 CIRCUIT

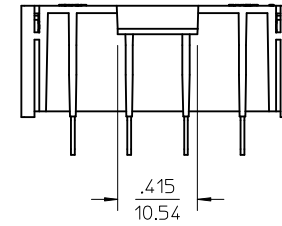

4 CIRCUIT

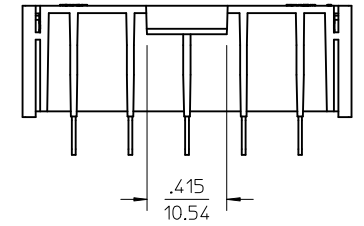

5 CIRCUIT

NOTES:

- MATERIALS
HOUSING: GLASS-FILLED, LIQUID CRYSTAL POLYMER (LCP), UL94V-0, LOW-HALOGEN, GLOW-WIRE CAPABLE, COLOR: BLACK
TERMINALS: ETP COPPER
- FINISHES:
.000100/.00254 MIN SELECT SILVER AND .000100/.00254 MIN SELECT MATTE TIN OVER NICKEL OVERALL
- PRODUCT SPECIFICATION:
PS-171825-001
- PACKAGING INFORMATION:
PK-43789-001 (TRAY PACK)
- MATES WITH:
171825 FEMALE CRIMP TERMINALS
172672 RECEPTACLE HOUSINGS
- THIS PART CONFORMS TO CLASS B REQUIREMENTS OF COSMETIC SPEC PS-45499-002.
- HEADERS INDICATED AS "FINGER-PROOF" ARE DESIGNED TO MINIMIZE ACCESSIBILITY TO LIVE PARTS, PER UL 1977 AND UL 60950 FINGER PROBE REQUIREMENTS.
- SLOTTED VIAS, PLATED THRU. MOLEX RECOMMENDS ANNULAR RING DESIGN PARAMETERS AS SPECIFIED IN IPC-2221, GENERIC STANDARD ON PRINTED BOARD DESIGN.
- 118/3.00 MOUNTING-HOLES (NON-PLATED) FOR OPTIONAL BOARD-LOCKS SHOWN.

REMOVE PARTS EC NO: UCP2016-3531 DRW:NBANDURA 2016/03/09 CHKD:NBANDURA 2016/03/09 APPR:FSMITH 2016/04/29	QUALITY SYMBOLS 	GENERAL TOLERANCES (UNLESS SPECIFIED)		DIMENSION STYLE IN/MM		SCALE 2:1	DESIGN UNITS INCH	THIRD ANGLE PROJECTION			
		4 PLACES ± --- ± --- 3 PLACES ± --- ± .005 2 PLACES ± .13 ± .010 1 PLACE ± 0.25 ± --- 0 PLACE ± --- ± ---		DRAWN BY DATE BANDERSON 2013/06/21		TITLE SUPER-SABRE RIGHT-ANGLE HEADER ASSY SINGLE-ROW molex		MATERIAL NO. SEE CHART		SHEET NO. 1 OF 2	
		ANGULAR ±1/2°		APPROVED BY DATE FSMITH 2013/12/06		DOCUMENT NO. SD-172043-001		DRAFT WHERE APPLICABLE MUST REMAIN WITHIN DIMENSIONS		THIS DRAWING CONTAINS INFORMATION THAT IS PROPRIETARY TO MOLEX INCORPORATED AND SHOULD NOT BE USED WITHOUT WRITTEN PERMISSION	
		DRAFT WHERE APPLICABLE MUST REMAIN WITHIN DIMENSIONS		SIZE 		DRAFT WHERE APPLICABLE MUST REMAIN WITHIN DIMENSIONS		DRAFT WHERE APPLICABLE MUST REMAIN WITHIN DIMENSIONS		DRAFT WHERE APPLICABLE MUST REMAIN WITHIN DIMENSIONS	

MATERIAL NUMBER*	CIRCUIT SIZE	SOLDER-TAIL	FINGER-PROOF	BOARD-LOCK
1720430201	2	SHORT	YES	NO
1720430202	2	SHORT	YES	YES
1720430205	2	LONG	YES	NO
1720430206	2	LONG	YES	YES
1720430301	3	SHORT	YES	NO
1720430302	3	SHORT	YES	YES
1720430305	3	LONG	YES	NO
1720430306	3	LONG	YES	YES
1720430401	4	SHORT	YES	NO
1720430402	4	SHORT	YES	YES
1720430405	4	LONG	YES	NO
1720430406	4	LONG	YES	YES
1720430501	5	SHORT	YES	NO
1720430502	5	SHORT	YES	YES
1720430505	5	LONG	YES	NO
1720430506	5	LONG	YES	YES
1720430601	6	SHORT	YES	NO
1720430602	6	SHORT	YES	YES
1720430605	6	LONG	YES	NO
1720430606	6	LONG	YES	YES
1720430801	8	SHORT	YES	NO
1720430802	8	SHORT	YES	YES
1720430805	8	LONG	YES	NO
1720430806	8	LONG	YES	YES

SOLDER-TAIL	DIM. "A" ±.020/0.51
SHORT	.150/3.81
LONG	.210/5.33

FINGER-PROOF	DIM. "B" (REF)
YES	.129/3.26

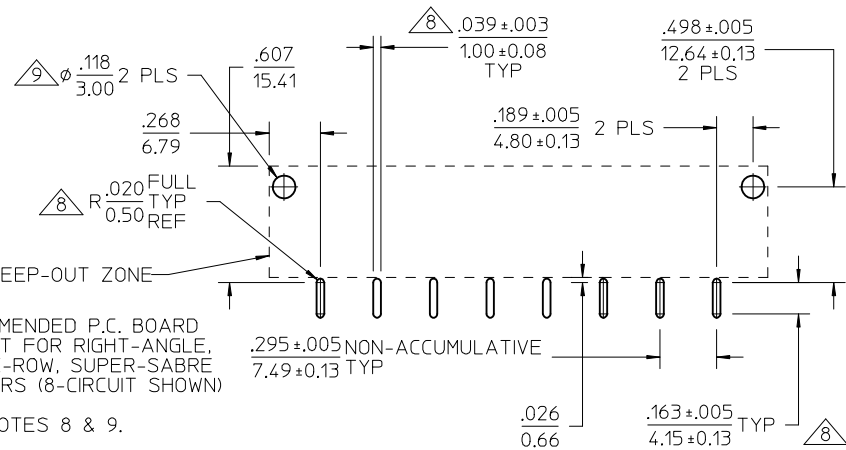
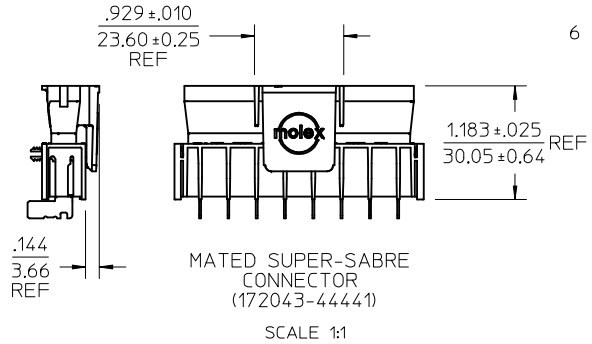
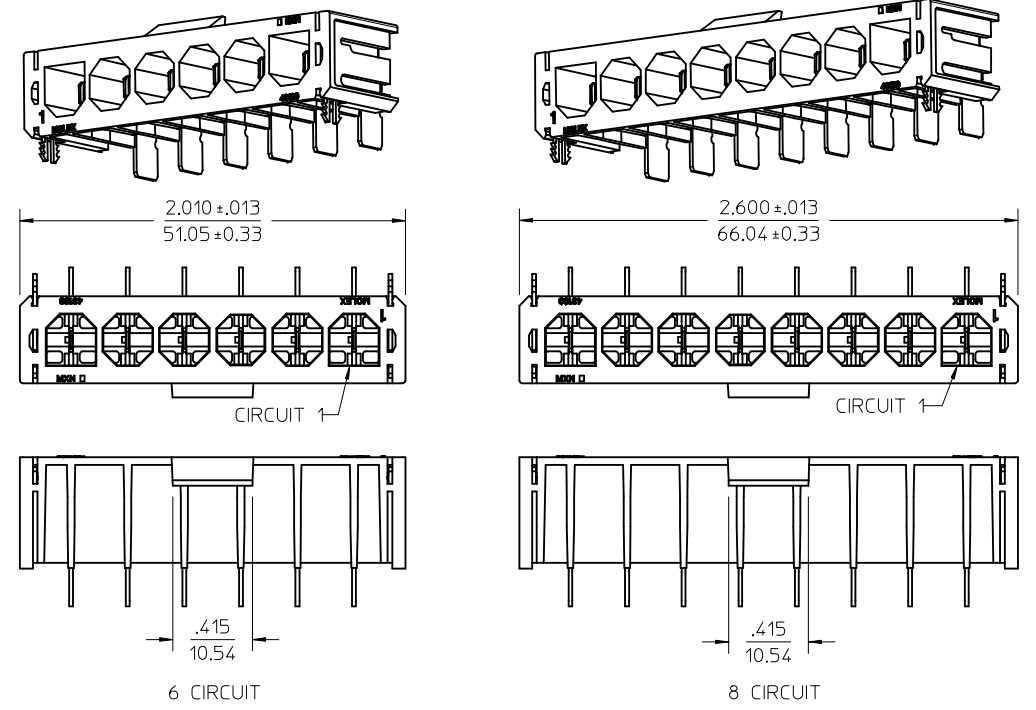

SEE NOTES 8 & 9.

SEE SHEET 1 EC NO: UCP2016-3531 DRWN: BANDURA 2016/03/09 CHKD: BANDURA 2016/03/09 APPR: FSMITH 2016/04/29	QUALITY SYMBOLS ∇=0 ∇=0 ∇=0	GENERAL TOLERANCES (UNLESS SPECIFIED) <table border="1"> <thead> <tr> <th></th> <th>mm</th> <th>INCH</th> </tr> </thead> <tbody> <tr> <td>4 PLACES</td> <td>± ---</td> <td>± ---</td> </tr> <tr> <td>3 PLACES</td> <td>± ---</td> <td>± .005</td> </tr> <tr> <td>2 PLACES</td> <td>± 0.13</td> <td>± .010</td> </tr> <tr> <td>1 PLACE</td> <td>± 0.25</td> <td>± ---</td> </tr> <tr> <td>0 PLACE</td> <td>± ---</td> <td>± ---</td> </tr> </tbody> </table>		mm	INCH	4 PLACES	± ---	± ---	3 PLACES	± ---	± .005	2 PLACES	± 0.13	± .010	1 PLACE	± 0.25	± ---	0 PLACE	± ---	± ---	DIMENSION STYLE IN/MM DRAWN BY: BANDERSON DATE: 2013/06/21 CHECKED BY: _____ DATE: _____ APPROVED BY: FSMITH DATE: 2013/12/06	SCALE: 2:1 DESIGN UNITS: INCH THIRD ANGLE PROJECTION
		mm	INCH																			
	4 PLACES	± ---	± ---																			
	3 PLACES	± ---	± .005																			
2 PLACES	± 0.13	± .010																				
1 PLACE	± 0.25	± ---																				
0 PLACE	± ---	± ---																				
DRAFT WHERE APPLICABLE MUST REMAIN WITHIN DIMENSIONS		MATERIAL NO. SEE CHART	TITLE: SUPER-SABRE RIGHT-ANGLE HEADER ASSY SINGLE-ROW molex DOCUMENT NO. SD-172043-001																			
		ANGULAR ±1/2°	SHEET NO. 2 OF 2																			
THIS DRAWING CONTAINS INFORMATION THAT IS PROPRIETARY TO MOLEX INCORPORATED AND SHOULD NOT BE USED WITHOUT WRITTEN PERMISSION																						