

ECHELLE 8.000

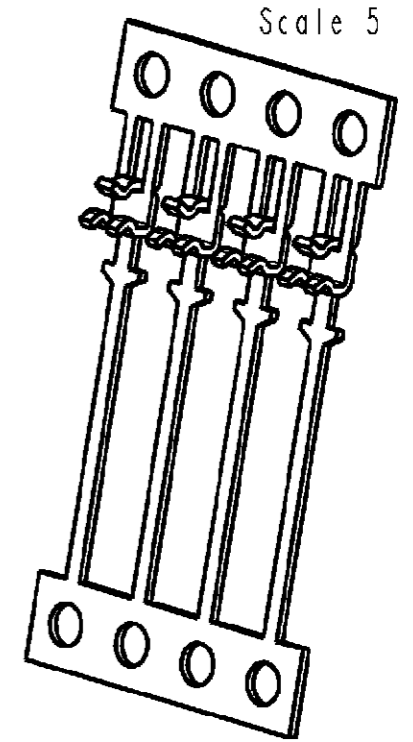
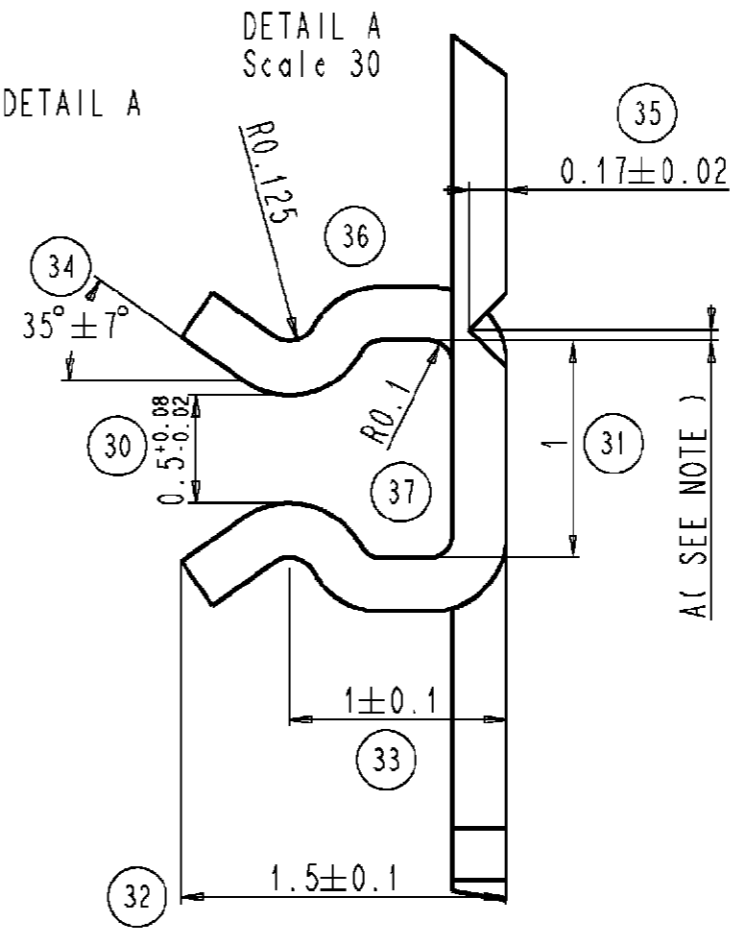
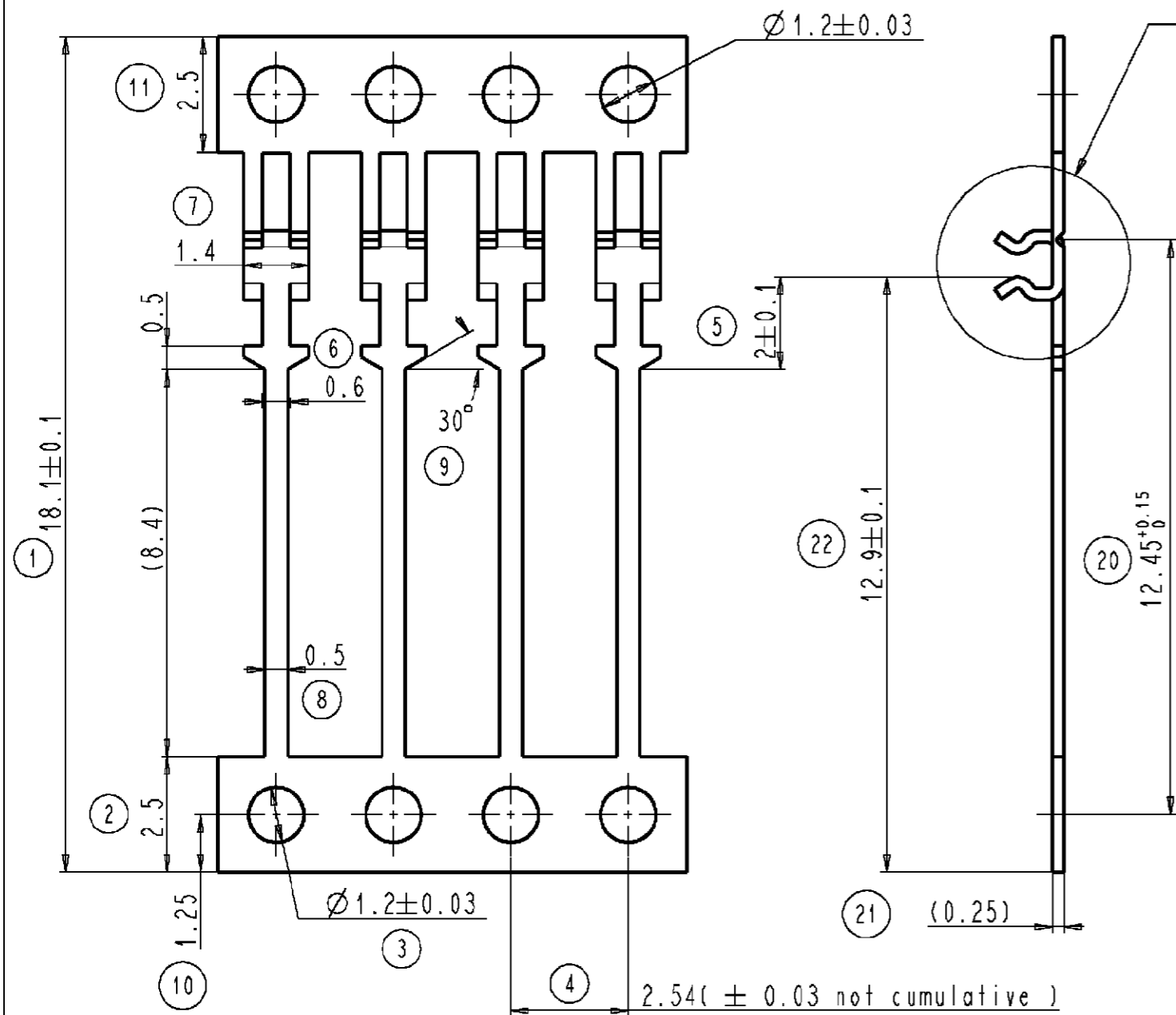

PRONER COMATEL P/N	TYCO ELECTRONICS P/N
519 1060 142 111	0-1544146-1
519 1060 144 111	0-1544146-2
519 1060 242 111	0-1544146-3
519 1060 244 111	0-1544146-4

Note : A= Breaking notch shall be outside the clip

Part number	PLATING
519 3955 X04 111	Bare
519 1060 X42 111	Sn: 112-16-4 3a 7 μ
519 1060 X44 111	Etamage: Ni: 112-25-3 1,27 à 3 μ Sn: 112-65-1 4 μ mini

	Phosphorous bronze		
see table	SM 105	/	35000 / bobine
Reference/designation	Material	/	Protection

Sub Assy.:		POUR DIFFUSION
Assembly :/		

Lead frame DIL



PRONER COMATEL

DEPARTEMENT TECHNIQUE

38530 CHAPAREILLAN

Tel: 04 76 45 34 34 Fax: 04 76 45 28 21

Scale: 10/1 Mass: /

Lin. Tol.: ± 0.05

Ang. Tol.: ± 7°

Size A3

4460 D 001

ER00-0283-04		SRd	8/6/04	B
MAJ pour maintenance outil, annule et remp. dwg 1060 G3	/	JD†	11/07/01	A1
Description of Modification	No. Modif.	Drawn by	Date	Checked by

Reproduction and diffusion forbidden without Proner Comatel agreement