

ELECTRICAL DATA

- I max 7.5A
- Contact resistance $\leq 7.3\text{m}\Omega$
- Insulation resistance >5000M Ω
- TEST VOLTAGE contact/contact >1000V
- contact/ground >1200V

MECHANICAL DATA

- Contact force >0.14N
- Retention force >40N
- Insertion force according to DIN41652 Part 2
- Withdrawal force according to DIN41652 Part 2
- Mechanical endurance :500 matings / unmatings
- Material shell steel, cadmium
- Material insulator glass filled thermoplastic UL94V0
- Material contacts pin:brass;
- Finish on contact area 0.4 μ gold over nickel
- Finish on termination end bright tin-Lead over nickel
- Solderability according to DIN 41640 Part 70, test 12a
- Shock according to DIN41640 Part 14, test 6c,50g
- Vibration according to DIN41640 Part 15, test 6d,20g
- 10 to 2000Hz:discontinuity$1\mu\text{s}$

ENVIRONMENTAL DATA

- Climatic category -55° / +125° /56
- Corrosion salt spray:48h

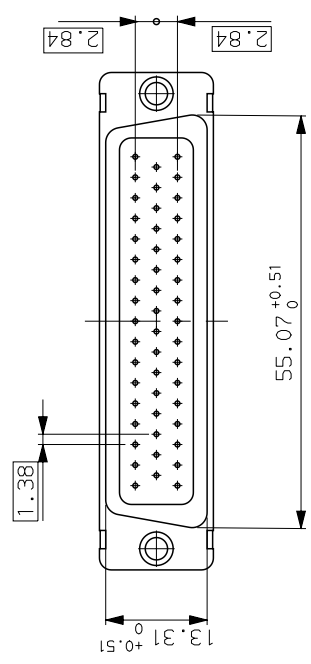
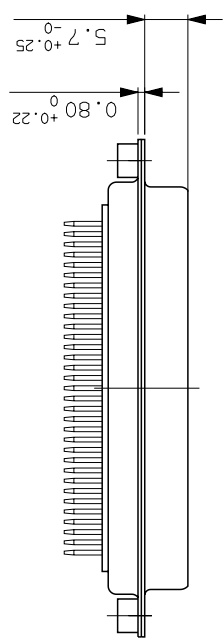
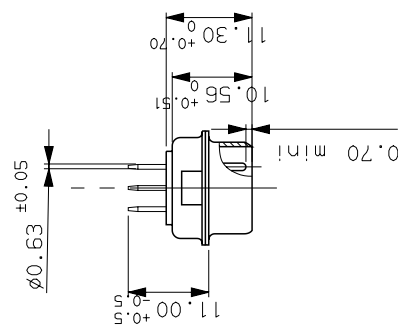
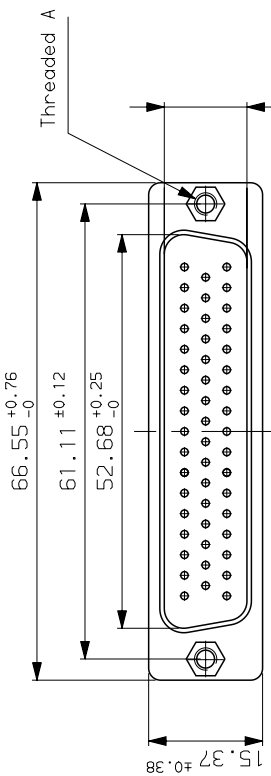

LAYOUT DIMENSIONS (after plating)

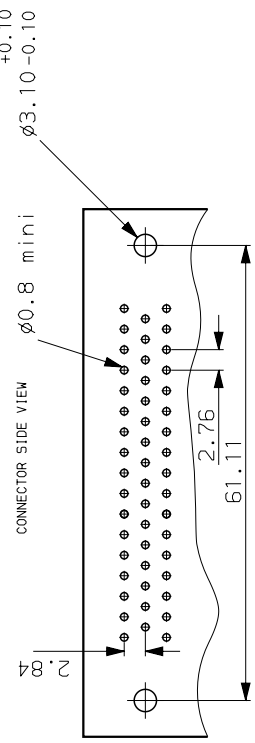

DDM050P300	UNC 4.40
DDML50P300	M3
PART NUMBER	Threaded A

Creation of drawing	23/12/03	JARRY	---	MOD N°	---
Latest modification by:	JARRY	date:23/12/03	Type of drawing:	CUSTOMER	SHEET 1/1
TITLE : PIN CONNECTORS SUB D WITH STRAIGHT SPILLS.					
SCALE:	1.5	FRAMATOME CONNECTORS FRANCE Rue Louis Bréguet - Bp 05 72024 LE MANS Cedex Tel. 33 (16) 43.84.08.43			
This document is the property of FRAMATOME CONNECTORS FRANCE. It must not be reproduced or communicated without permission in writing from the owners.					
FORMAT	A3	SOURIAU DRG N°	PROJECT M94D001		
C01-8637-1638					