

PC board drilling dimensions(after plating)
(thickness ≤ 3.20±0.30mm)

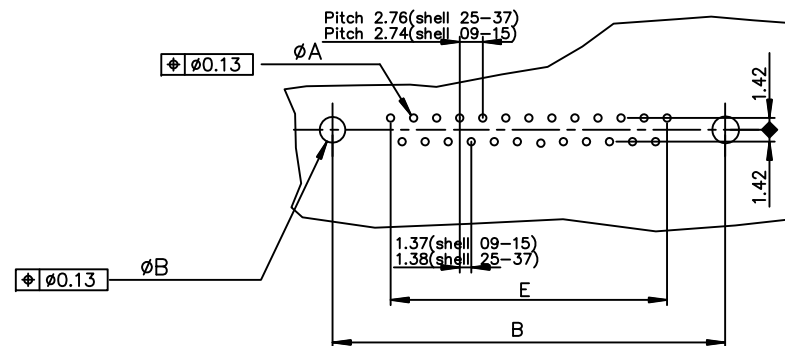

Notes:

1) The nut can protrude above the surface of insulator but maintaining the footprint dimension 5.6±0.15 mm.

LEAD FREE PART NUMBER

SHELL	A±0.38	B±0.12	C±0.10	D±0.25	E±0.07	PART NUMBER	PART NUMBER
09	30.81	24.99	16.96	16.21	10.96	D09S90C4P*00LF	D09S90C6P*00LF
15	39.14	33.32	25.18	24.54	19.18	D15S90C4P*00LF	D15S90C6P*00LF
25	53.03	47.04	39.12	38.25	33.12	D25S90C4P*00LF	D25S90C6P*00LF
37	69.32	63.50	55.68	54.71	49.68	D37S90C4P*00LF	D37S90C6P*00LF

Thru-hole ØT M3 = L
Thru-hole ØT 4.40 = X

GENERAL CHARACTERISTICS AND ROHS INFORMATIONS:

SEE DRAWING C01-8646-0001

mat'l. code		surface ISO 1302		tolerance ISO 406 ISO 1101		projection		product family	
-		✓		tolerances unless otherwise specified		MM		D-SUB	
Ltr	ecn no	dr	date	angles		linear		title	
E	ELX-I-21256	AB	2015/07/14	0°±2'		.0±0.1 .00±0.1 .000±0.1		FEMALE CONNECTOR DELTA-D LOW PROFILE STRAIGHT PRESS-FIT	
sheet index		revision	E	dr		PESSON 1996-07-23		dwg no	
1		1		engr		ALIAS BABU 2015/07/14		sheet 1 of 1	
				chr		MITHUN PAUL 2015/07/14		size	
				appd		BIJU K PAUL 2015/07/14		A3	
				type		Product Customer Drawing			