

PC card drilling dimensions(after plating)
(thickness 1.60±0.20mm)

Part Number & Date Code Printing

SHELL	A±0.38	B±0.12	C±0.10	D±0.25	Plating: 0.76» AU	Plating: Flash AU
09	30.81	24.99	16.96	16.21	D09S13B6G*00**	D09S13B4G*00**
15	39.14	33.32	25.18	24.54	D15S13B6G*00**	D15S13B4G*00**
25	53.03	47.04	39.12	38.25	D25S13B6G*00**	D25S13B4G*00**
37	69.32	63.50	55.68	54.71	D37S13B6G*00**	D37S13B4G*00**

Threaded ØT M3 = L
Threaded ØT 4.40 = X
LF FOR LEAD FREE

REQUIREMENTS

- Technical characteristics:**
 Shell: steel tin plated
 Insulators: self-extinguishing black polyster, ULclass94V0
 Contacts size 20: brass, gold 0.76» on mating end, bright tin on termination end over nickel on entire contact
 Cycles : 200 for plating 4
 500 for plating 6
 Harpoons: phosphor bronze, tin plated
 Metal plate for electrical continuity: brass, tin plated
 Nuts: brass, tin plated
- Electrical characteristics:**
 max. current rating: 5A
 Test voltage: 1000V
 Rated voltage: 300V
 Contact resistance: ?15m?
 Shell resistance: ?5m?
 Insulation resistance: *5000M?
- Climatic characteristics:**
 Operating temperature range: -55°c +125°c
- Dimensions:**
 in accordance with MIL-C-24308

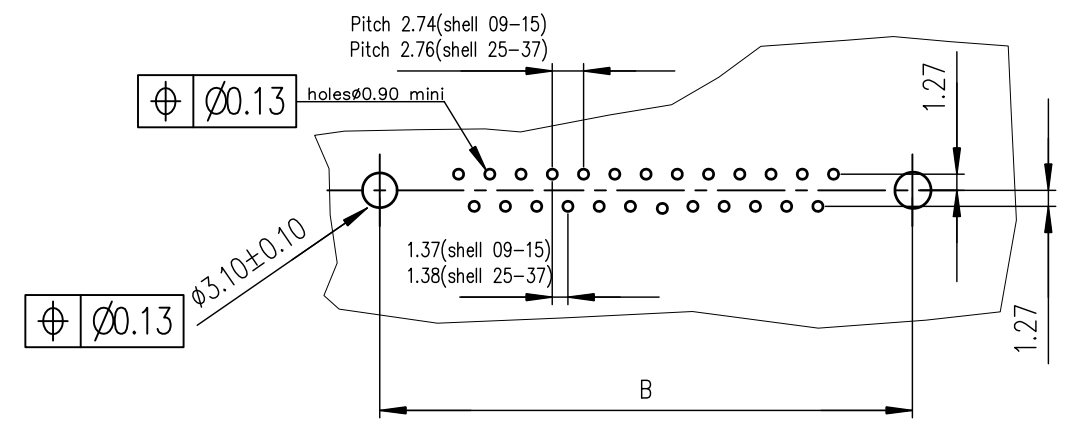

FOR ROHS DETAILS REFER DWG.NO: C01-8646-0000

mat'l. code		surface		tolerance		projection		product family	
SEE.NOTES		ISO 1302	ISO 406	ISO 1101	MM		D-SUB		
ltr	ecn no	dr	date	tolerances unless otherwise specified		MM		title	
D	I05-0124	JS	2005/07/27	angles	linear	1:1		SOCKET CONNECT.DELTA-D RIGHT ANGLED	
E	I05-0074	SK	2006/05/08					WITH NUT, HARPOON & METAL PLATE	
F	ELXI-I-15060	AB	2013/06/25	X±1°					
		dr	JOHN.SLEEBA	1994/08/01			dwg no		
		enr	ALIAS.BABU	2013/06/25			sheet 1 of 1		
		chr	MITHUN.PAUL	2013/06/25			size		
		appd	BIJU.K.PAUL	2013/06/25			5		
sheet index		revision	F	-	-	-	-	C01-8646-0295	
sheet		1	-	-	-	-	-	A3	
								type	
								CUSTOMER Drawing	