

PC card drilling dimensions(after plating)
(thickness 1.60±0.20mm)

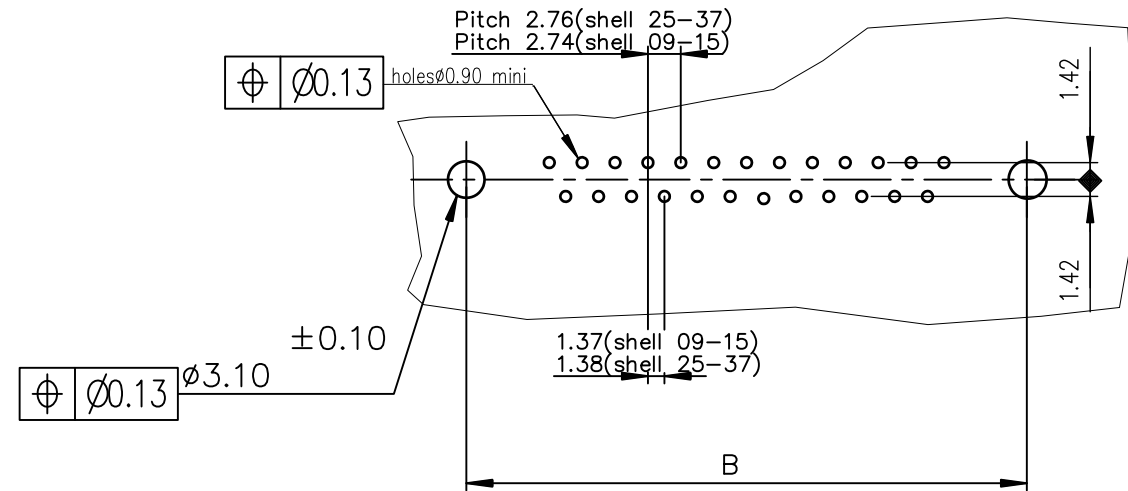

Part Number & Date Code Printing

SHELL	A±0.38	B±0.12	C±0.10	D±0.25	G±0.25	PART NUMBER	
09	30.81	24.99	16.96	16.79	5.90	D09P23B4PA00**	D09P23B6PA00**
15	39.14	33.32	25.18	25.12	5.90	D15P23B4PA00**	D15P23B6PA00**
25	53.03	47.04	39.12	38.84	5.70	D25P23B4PA00**	D25P23B6PA00**
37	69.32	63.50	55.68	55.30	5.70	D37P23B4PA00**	D37P23B6PA00**

Gold flash 0,76 µ gold

REQUIREMENTS

Technical characteristics:

Shell: steel tin plated/Zinc Cr3 plated
Insulators: self-extinguishing black polyster, ULclass94V0
Contacts size 20: brass, gold on mating end, bright tin on termination end over nickel on entire contact

Cycles : 500 mini for plating 6
: 200 mini for plating 4

Electrical characteristics:

max.current rating: 5A
Test voltage: 1000V
Rated voltage: 300V
Contact resistance: ≤25mΩ
Shell resistance: ≤5mΩ
Insulation resistance: ≥ 5000MΩ

Climatic characteristics:

Operating temperature range: -55°C +125°C

Dimensions:

in accordance with MIL-C-24308

LF FOR LEAD FREE

FOR ROHS DETAILS REFER DWG.NO: C01-8646-0000

mat'l. code		surface		tolerance		projection		product family			
SEE.NOTES		ISO 1302 ✓		ISO 406 ISO 1101				D-SUB			
ltr	ecn no	dr	date	tolerances unless otherwise specified		MM		title			
B	105-0124	JS	2005/07/27	angles	linear	O.X ±0.1		MALE CONNECT. DELTA D RIGHT ANGLE			
C	106-0074	SK	2006/06/08			O.XX ±0.1		SPILL WITHOUT ACCESSORIES			
D	ELXI-I-15060	AB	2013/06/25	X±1°		O.XXX±0.1		scale 1:1			
		dr	JOHN.SLEEBA	1994/08/16				dwg no			
		enr	ALIAS.BABU	2013/06/25				sheet 1 of 1		size 5	
		chr	MITHUN.PAUL	2013/06/25				C01-8646-0745		A3	
		appd	BIJU.K.PAUL	2013/06/25				type			
sheet index		revision sheet		D 1				CUSTOMER Drawing			