

SHELL	A±0.38	B±0.12	C±0.10	D±0.25	G±0.25	PART NUMBER		
09	30.81	24.99	16.96	16.79	5.90	--	D09P13A6GX00**	D09P13A8GX00**
15	39.14	33.32	25.18	25.12	5.90	--	D15P13A6GX00**	D15P13A8GX00**
25	53.03	47.04	39.12	38.84	5.70	--	D25P13A6GX00**	D25P13A8GX00**
37	69.32	63.50	55.68	55.30	5.70	D37P13A4GX00**	D37P13A6GX00**	D37P13A8GX00**

GENERAL CHARACTERISTICS • SEE DRAWING C01-8646-0000

Part Number & Date Code Printing

LF FOR LEAD FREE

PC card drilling dimensions(after plating)
(thickness 1.60±0.20mm)

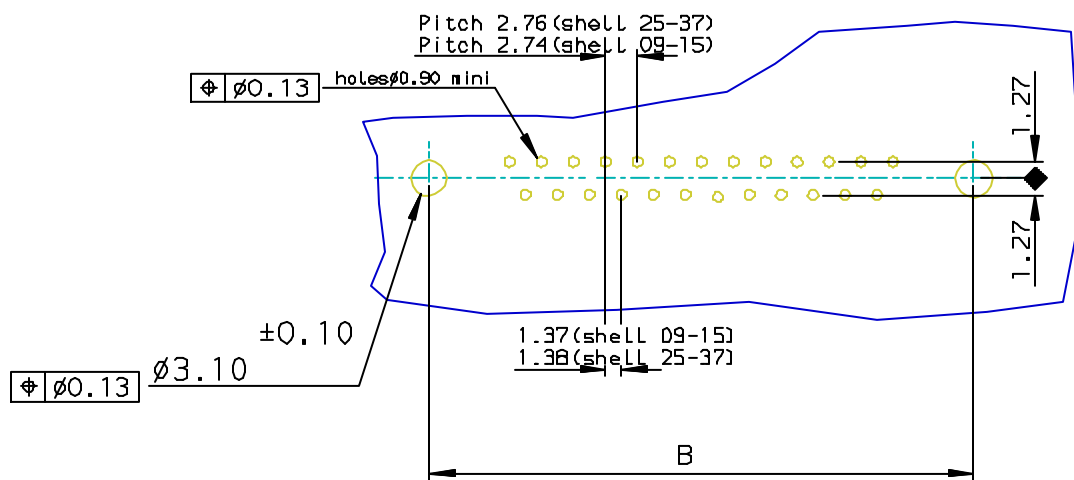

rev	ecn no	dr	date
B	105-0124	JS	2005/07/27
C	106-0074	SK	2006/06/08
-	-	-	-
-	-	-	-
-	-	-	-
-	-	-	-

www.fciconnect.com		surface ISO 1302 ✓	tolerance std ISO 406 ISO 1101	projection mm
TOLERANCES UNLESS OTHERWISE SPECIFIED				
Dr	JOHN SLEEBA	1994/08/01	ANGULAR	0.X ±0.1
Eng	GEORGE VJ	1994/08/01	LINEAR	0.XX ±0.1
Chr	GEORGE VJ	2005/07/27	0.XX* ±1*	0.XXX ±0.1
Appr	KVSD	2005/07/27	Product family	D-SUB
title MALE CONNECT.DELTA D RIGHT ANGLED WITH NUT, HARPOON & METAL PLATE.			size A3	Scale 1:1
catalog no DELTA-D			ECN	-
Rev.			spec ref	-
C01-8646-0830			Rev.	C
CUSTOMER			sheet	1 of 1

REV F - 2006-04-17