

REVISIONS				
SYM	ZONE	ECN, ERN NO.	DATE	APPRD.
A		PROPOSAL	MAR29/06	L.CHAN

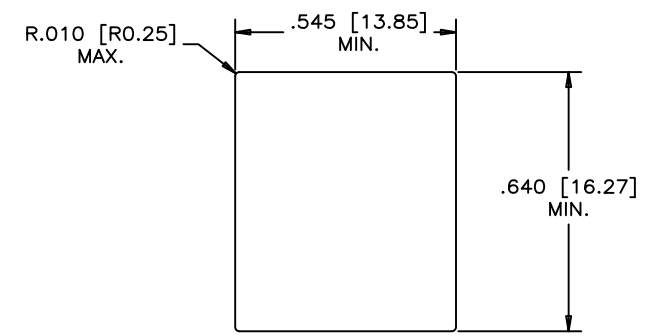

**RECOMMENDED PANEL CUTOUT**

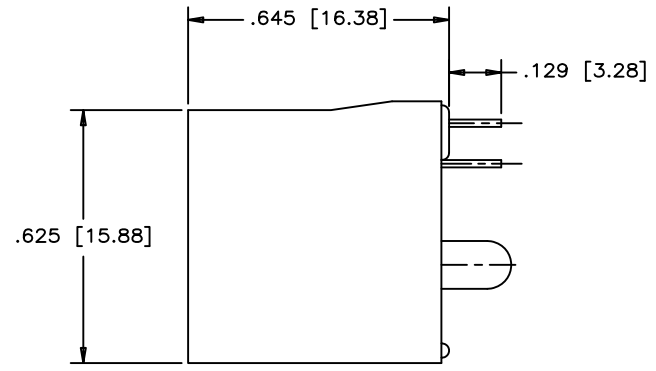
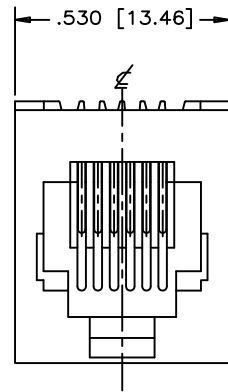
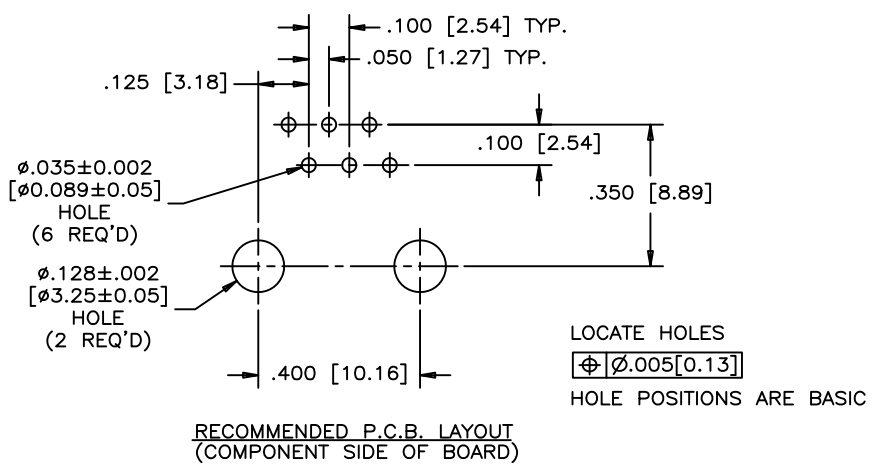

**RECOMMENDED P.C.B. LAYOUT  
(COMPONENT SIDE OF BOARD)**

**MATERIALS:**

PLASTIC HOUSING: ENGINEERING THERMOPLASTIC  
FLAMMABILITY RATING UL 94V-0

CONTACTS: PHOSPHOR BRONZE  
PLATING: REFER TO PART NUMBER FOR GOLD THICKNESS ON MATING SURFACES.  
50  $\mu$ " [1.27 MICRONS]  
MIN. NICKEL UNDERPLATE  
100  $\mu$ " [2.54 MICRONS]  
MIN. MATTE TIN ON CONTACT TAILS.

RECOMMENDED SOLDERING TEMPERATURE:  
WAVE SOLDERING AT 240°C MAXIMUM FOR 5 SEC MAXIMUM.

**PART NUMBER: RJE08-166-0X10**

**GOLD PLATING:**

- 1 = 6  $\mu$ "
- 2 = 15  $\mu$ "
- 3 = 30  $\mu$ "
- 4 = 50  $\mu$ "

THIS DOCUMENT CONTAINS PROPRIETARY INFORMATION AND SUCH INFORMATION MAY NOT BE DISCLOSED TO OTHERS FOR ANY PURPOSE OR USED FOR MANUFACTURING PURPOSES WITHOUT WRITTEN PERMISSION FROM AMPHENOL CANADA CORP.

DRAWN PAULW	DATE 06/03/29	<b>Amphenol Canada Corp.</b>		
DESIGNED				
CHECKED CHIGOW	DATE 06/03/29	TITLE MODULAR JACK, 6 POSITION, 6 CONTACTS, TOP ENTRY WITHOUT SHIELD, WITHOUT FLANGE - RoHS COMPLIANT		
I. E. APPRD.				
Q. A. APPRD.		REV. A		
DWG. APPRD.				
ENG. REL. NO.		DWG	DRAWING NO.	
REF. EAR 060332		P-RJE08-166-0X10		
DIMENSIONS ARE IN INCHES [mm]	CODE ID. NO. 03554	SCALE	WT. -----	SURF. -----
			SHEET 1 OF 1	