

10 9 8 7 6 5 4 3 2 1

PART NUMBERS IN TRAY	PART NUMBERS IN T&R	HOLD DOWN OPTION
87975-1001	87975-1011	FORK LOCK
87975-1002	87975-1012	BLADE

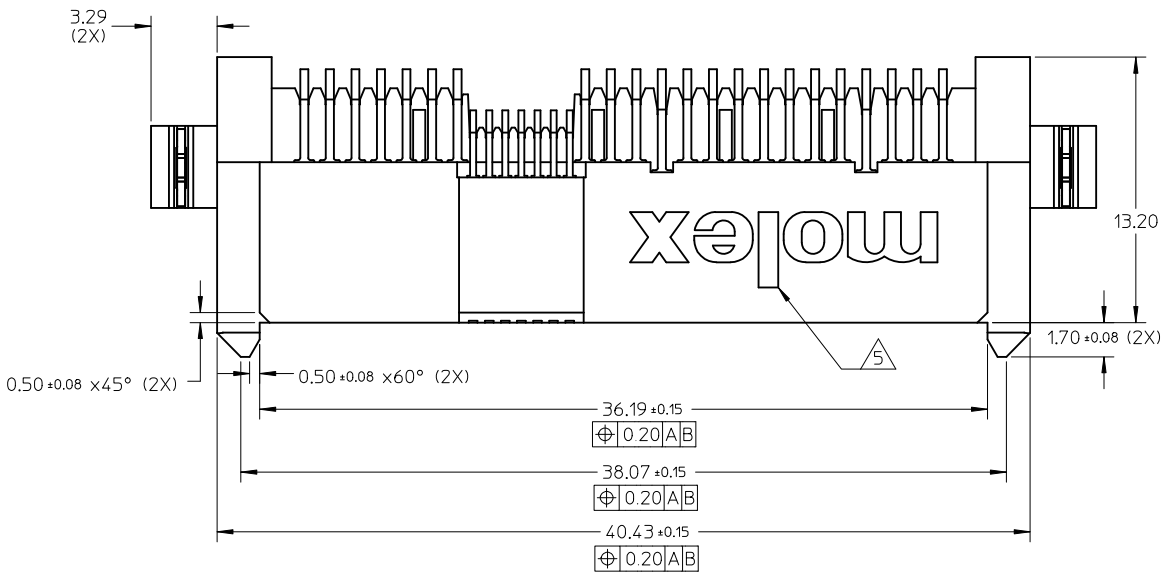

- NOTES:
- MATERIAL:  
HOUSING: NYLON, GLASS FILLED, UL 94V-0, BLACK.  
TERMINAL/FORKLOCK/BLADE : COPPER ALLOY.
  - FINISHES:  
TERMINAL:  
CONTACT: 0.76µm MIN. SELECTIVE GOLD OVER 1.27µm MIN. NICKEL UNDERPLATE.  
SOLDERTAIL: 2.54µm MIN. TIN OVER 1.27µm MIN. NICKEL UNDERPLATE.  
FORKLOCK/BLADE: 2.54µm MIN. TIN OVER 1.27µm MIN. NICKEL UNDERPLATE.
  - PRODUCT SPECIFICATION: PS-87975-102
  - PACKAGING SPECIFICATION : TRAY.
  - MOLEX LOGO AND DATE CODE LOCATED APPROXIMATELY AS SHOWN.
  - NON FUNCTIONAL CORE HOLE MAY VARY.
  - THIS PRODUCT IS COMPLIANT TO RoHS DIRECTIVE WITH THE FOLLOWING BANNED SUBSTANCES - LEAD, MERCURY, CADMIUM, HEXAVALENT CHROMIUM, POLYBROMINATED BIPHENYLS AND POLYBROMINATED DIPHENYL ETHERS.
  - MATES WITH : SFF-8482 PLUG  
SATA PLUG SERIES 87679, 87703 AND 87799

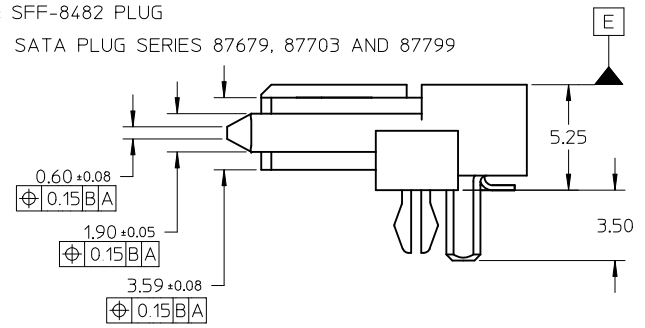
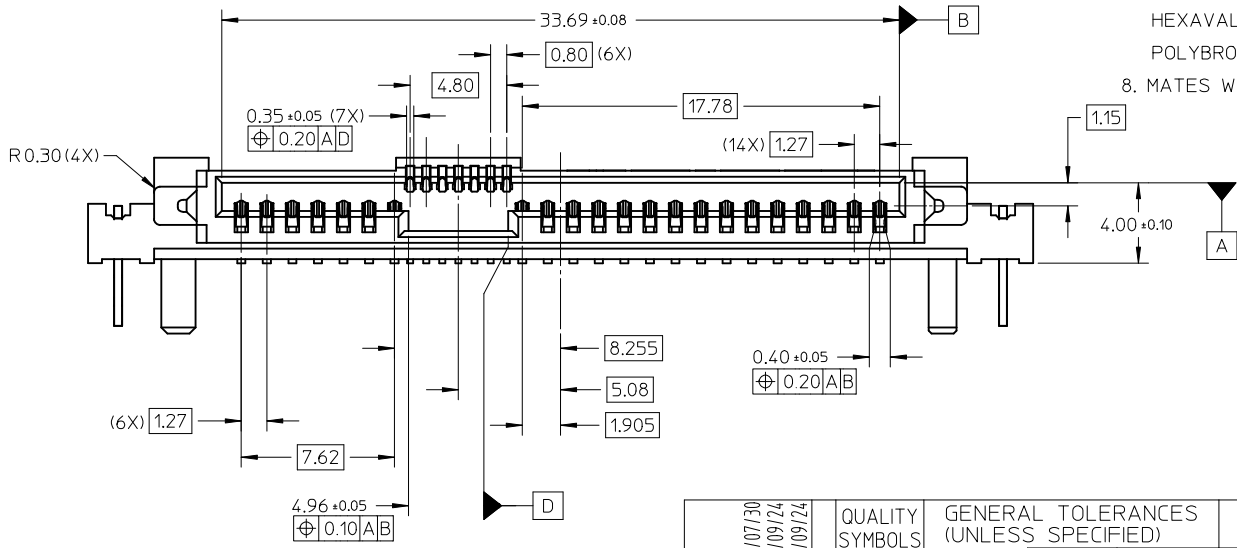

9 8 7 6 5 4 3 2 1

REVISED EC NO: S2011-0079 DRW:SKANG 2010/07/30 CHKD:ATSEE 2010/09/24 APPR:MLONG 2010/09/24	REV	DESCRIPTION	QUALITY SYMBOLS	GENERAL TOLERANCES (UNLESS SPECIFIED)	DIMENSION STYLE	SCALE	DESIGN UNITS	THIRD ANGLE PROJECTION	
	A2		$F_{\sqrt{3}}=0$ $F_{\sqrt{2}}=0$ $F_{\sqrt{1}}=0$	mm INCH 4 PLACES ± --- ± --- 3 PLACES ± --- ± --- 2 PLACES ± 0.20 ± --- 1 PLACE ± --- ± --- ANGULAR ± 3 °	MM ONLY	NTS	METRIC		
				DRAFT WHERE APPLICABLE MUST REMAIN WITHIN DIMENSIONS	DRAWN BY: YKOH CHECKED BY: DKOH APPROVED BY: MLONG MATERIAL NO.: SEE TABLE SIZE: A3	DATE: 2005/03/16 DATE: 2005/03/23 DATE: 2010/09/24	TITLE	SERIAL ATTACH SCSI RECEPTACLE, RIGHT-ANGLE SMT, 2.85MM HEIGHT MOLEX INCORPORATED DOCUMENT NO.: SD-87975-101	SHEET NO.: 1 OF 5
	THIS DRAWING CONTAINS INFORMATION THAT IS PROPRIETARY TO MOLEX INCORPORATED AND SHOULD NOT BE USED WITHOUT WRITTEN PERMISSION								

10 9 8 7 6 5 4 3 2 1

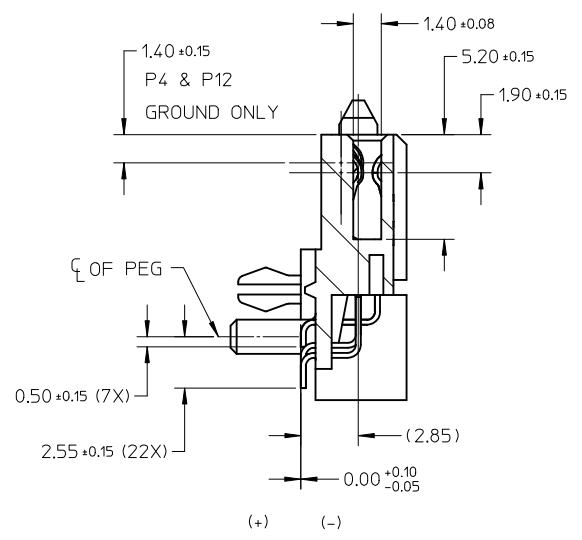
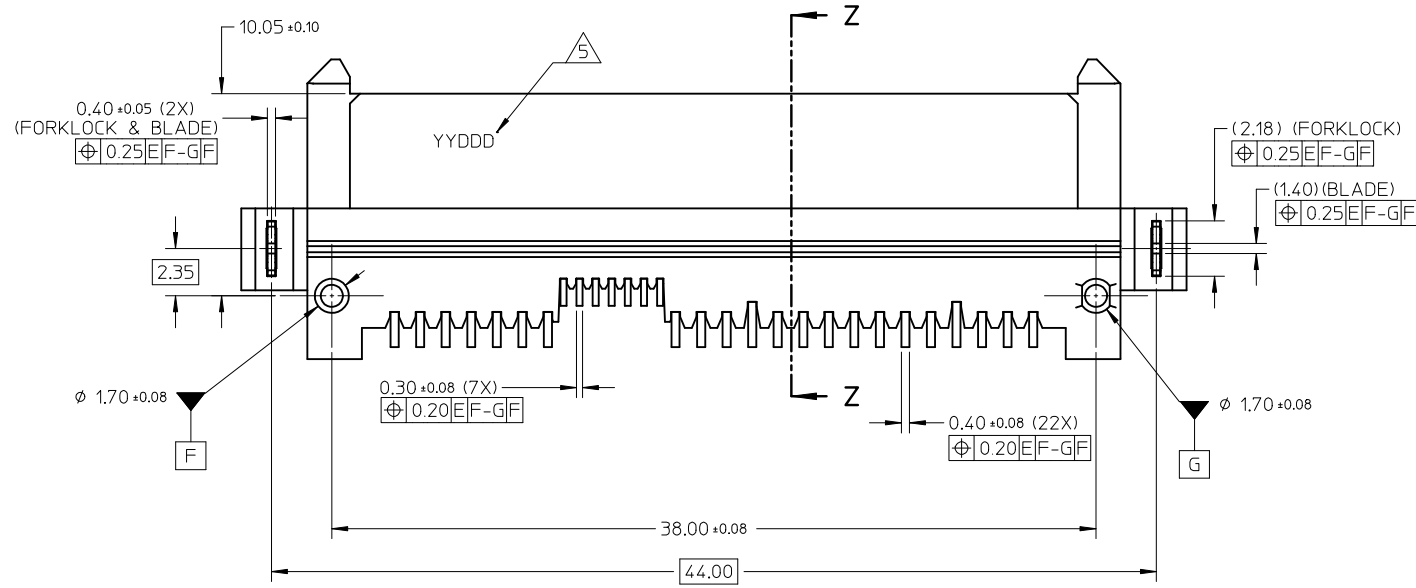
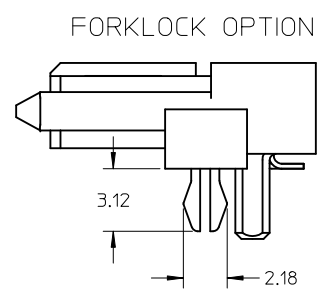
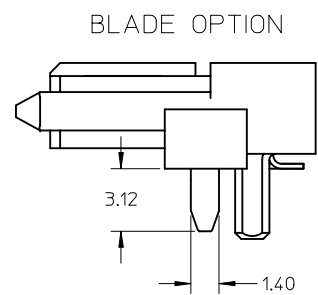
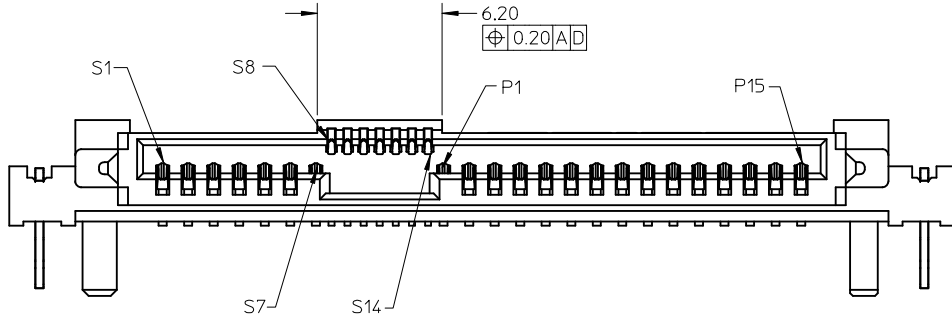

SECTION Z-Z

REVISED IEC NO: S2011-0079 DRWN:SKANG 2010/07/30 CHKD:ATSE 2010/09/24 APPR:MLONG 2010/09/24	DESCRIPTION REV	QUALITY SYMBOLS	GENERAL TOLERANCES (UNLESS SPECIFIED)		DIMENSION STYLE		SCALE	DESIGN UNITS	THIRD ANGLE PROJECTION		
		$\nabla = 0$ $\nabla = 0$ $\nabla = 0$	mm	INCH	MM ONLY	NTS	METRIC	TITLE		SERIAL ATTACH SCSI RECEPTACLE, RIGHT-ANGLE SMT, 2.85MM HEIGHT  MOLEX INCORPORATED	
		4 PLACES ± --- ± --- 3 PLACES ± --- ± --- 2 PLACES ± 0.20 ± --- 1 PLACE ± --- ± ---			DRAWN BY YKOH DATE 2005/03/16 CHECKED BY DKOH DATE 2005/03/23 APPROVED BY MLONG DATE 2010/09/24						
					ANGULAR ± 3 °			MATERIAL NO. SEE TABLE DOCUMENT NO. SD-87975-101		SHEET NO. 2 OF 5	

DRAFT WHERE APPLICABLE MUST REMAIN WITHIN DIMENSIONS

THIS DRAWING CONTAINS INFORMATION THAT IS PROPRIETARY TO MOLEX INCORPORATED AND SHOULD NOT BE USED WITHOUT WRITTEN PERMISSION

9 8 7 6 5 4 3 2 1

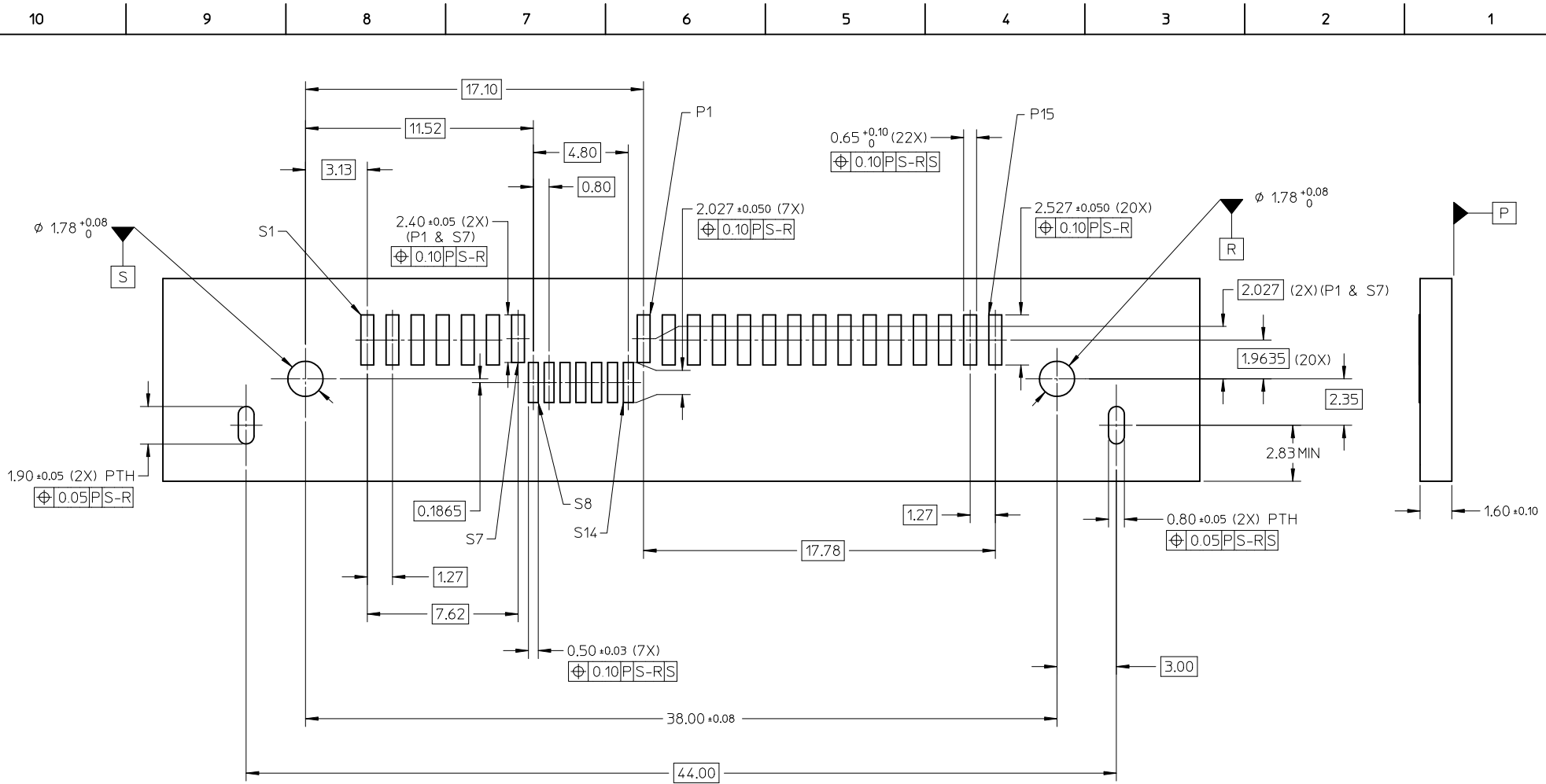

RECOMMENDED PCB LAYOUT

<b>REVISED</b> EC NO: S2011-0079 DRW:SKANG CHKD:ATSEE APPR:MLONG 2010/07/30 2010/09/24 2010/09/24	QUALITY SYMBOLS $F_A=0$ $F_B=0$ $F_C=0$	GENERAL TOLERANCES (UNLESS SPECIFIED) mm INCH 4 PLACES ± --- ± --- 3 PLACES ± --- ± --- 2 PLACES ± 0.20 ± --- 1 PLACE ± --- ± --- ANGULAR ± 3 °	DIMENSION STYLE <b>MM ONLY</b> DRAWN BY: YKOH CHECKED BY: DKOH APPROVED BY: MLONG MATERIAL NO. SEE TABLE	SCALE: NTS DESIGN UNITS: METRIC THIRD ANGLE PROJECTION	TITLE: SERIAL ATTACH SCSI RECEPTACLE, RIGHT-ANGLE SMT, 2.85MM HEIGHT MOLEX INCORPORATED DOCUMENT NO. SD-87975-101 SHEET NO. 3 OF 5
	DRAFT WHERE APPLICABLE MUST REMAIN WITHIN DIMENSIONS	THIS DRAWING CONTAINS INFORMATION THAT IS PROPRIETARY TO MOLEX INCORPORATED AND SHOULD NOT BE USED WITHOUT WRITTEN PERMISSION			
	SIZE: A3	THIS DRAWING CONTAINS INFORMATION THAT IS PROPRIETARY TO MOLEX INCORPORATED AND SHOULD NOT BE USED WITHOUT WRITTEN PERMISSION			
	REV: A2	THIS DRAWING CONTAINS INFORMATION THAT IS PROPRIETARY TO MOLEX INCORPORATED AND SHOULD NOT BE USED WITHOUT WRITTEN PERMISSION			

10 9 8 7 6 5 4 3 2 1

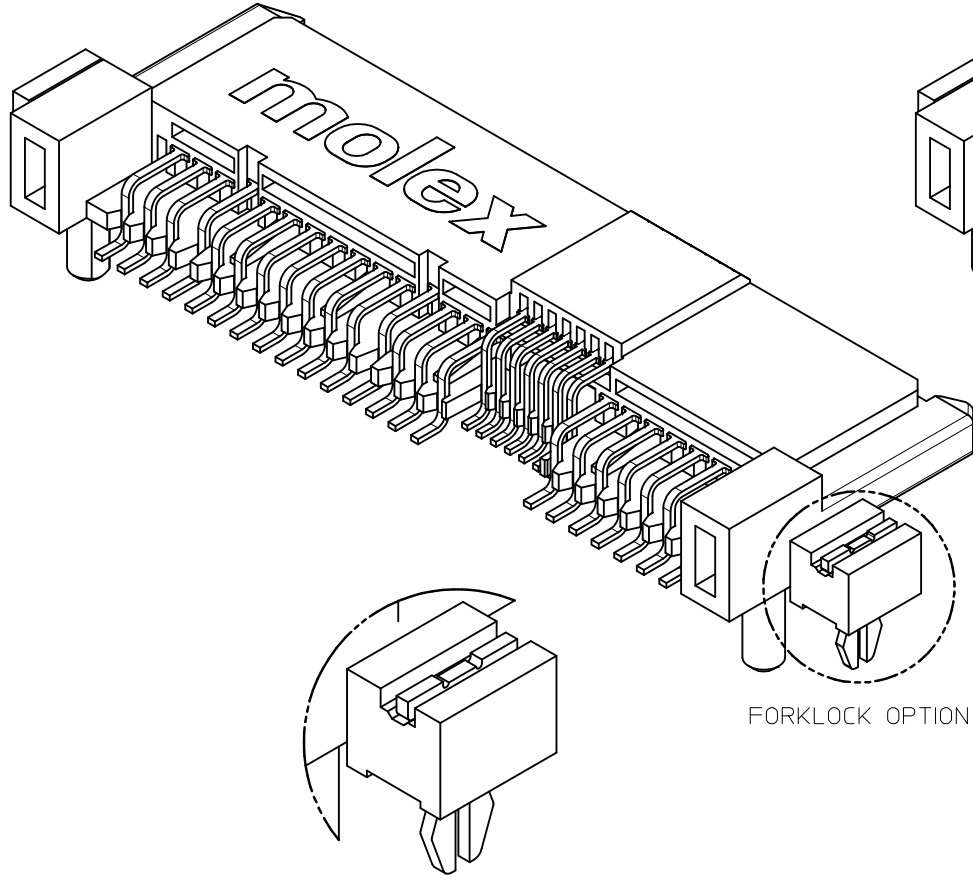

FORKLOCK OPTION

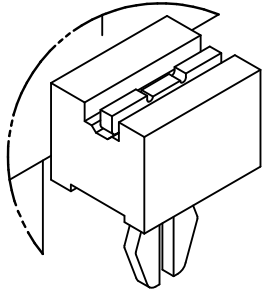

FORKLOCK OPTION

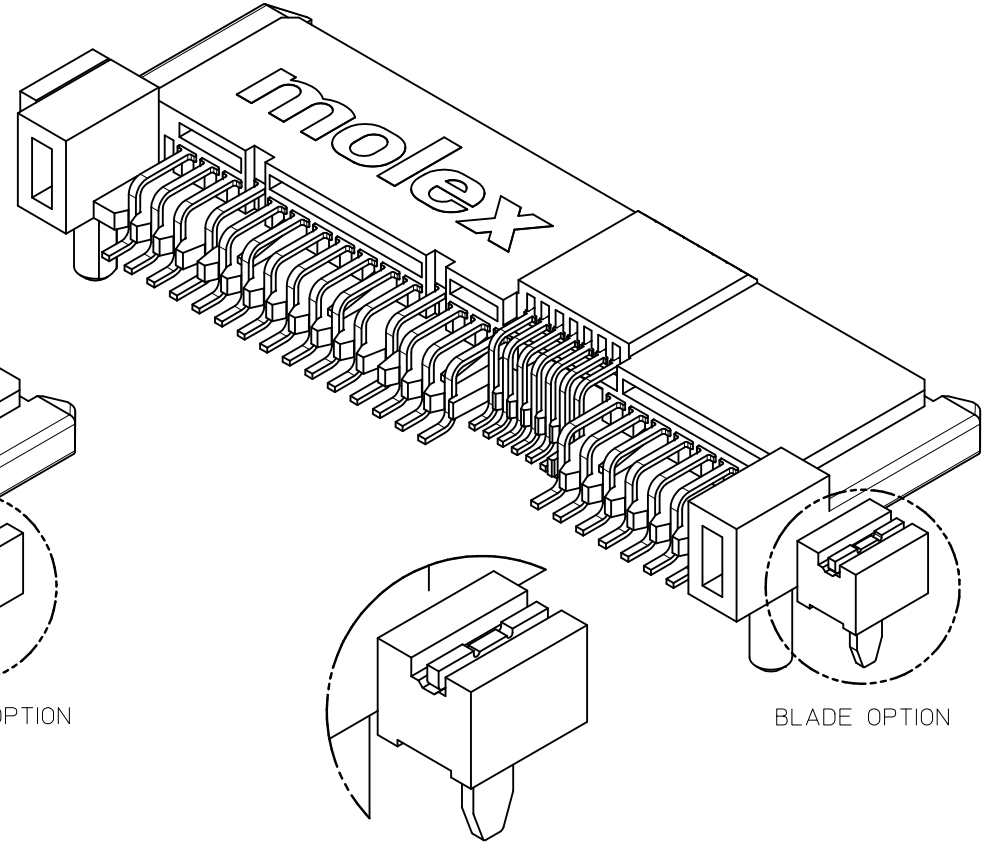

BLADE OPTION

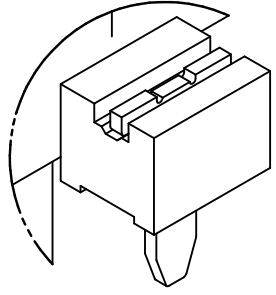

BLADE OPTION

<b>REVISED</b> EC NO: S2011-0079 DRWN:SKANG 2010/07/30 CHKD:ATSEE 2010/09/24 APPR:MLONG 2010/09/24	QUALITY SYMBOLS $\nabla_A = 0$ $\nabla_B = 0$ $\nabla_C = 0$	GENERAL TOLERANCES (UNLESS SPECIFIED) <table border="1"> <thead> <tr> <th></th> <th>mm</th> <th>INCH</th> </tr> </thead> <tbody> <tr> <td>4 PLACES</td> <td>± ---</td> <td>± ---</td> </tr> <tr> <td>3 PLACES</td> <td>± ---</td> <td>± ---</td> </tr> <tr> <td>2 PLACES</td> <td>± 0.20</td> <td>± ---</td> </tr> <tr> <td>1 PLACE</td> <td>± ---</td> <td>± ---</td> </tr> </tbody> </table>		mm	INCH	4 PLACES	± ---	± ---	3 PLACES	± ---	± ---	2 PLACES	± 0.20	± ---	1 PLACE	± ---	± ---	DIMENSION STYLE <b>MM ONLY</b>	SCALE NTS	DESIGN UNITS METRIC	THIRD ANGLE PROJECTION
		mm	INCH																		
	4 PLACES	± ---	± ---																		
	3 PLACES	± ---	± ---																		
2 PLACES	± 0.20	± ---																			
1 PLACE	± ---	± ---																			
DESCRIPTION REV	ANGULAR ± 3 °	DRAFT WHERE APPLICABLE MUST REMAIN WITHIN DIMENSIONS	DRAWN BY YKOH	DATE 2005/03/16	TITLE SERIAL ATTACH SCSI RECEPTACLE, RIGHT-ANGLE SMT, 2.85MM HEIGHT	MOLEX INCORPORATED															
A2			CHECKED BY DKOH	DATE 2005/03/23	APPROVED BY MLONG	DATE 2010/09/24															
			MATERIAL NO. SEE TABLE	DOCUMENT NO. SD-87975-101	SHEET NO. 4 OF 5	THIS DRAWING CONTAINS INFORMATION THAT IS PROPRIETARY TO MOLEX INCORPORATED AND SHOULD NOT BE USED WITHOUT WRITTEN PERMISSION															

9 8 7 6 5 4 3 2 1

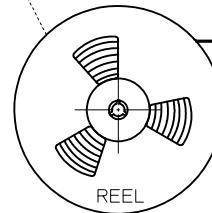
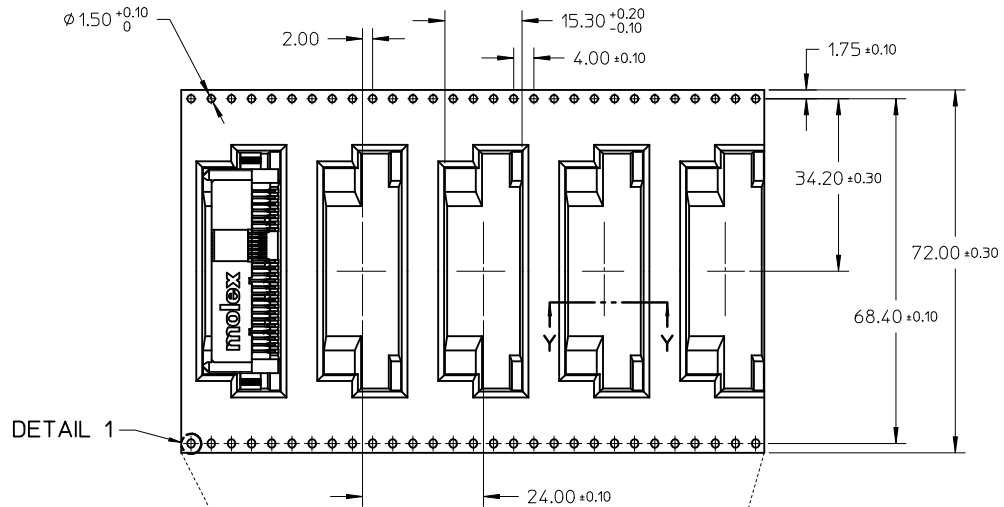
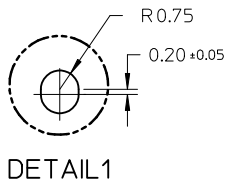

PULL OUT DIRECTION

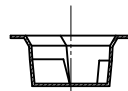

NOTES:

1. LEADER AND TRAILER TAPE

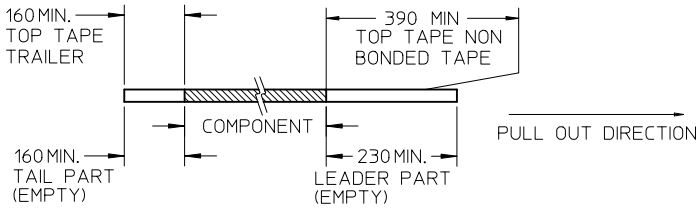

2. PEELING OFF FORCE OF THE TOP TAPE: 20 - 80gf.  
(PEELING DIRECTION AS SHOWN IN FOLLOWING FIGURE)

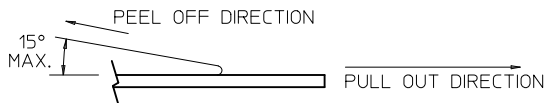

- 3. TAPE AND REEL SPECIFICATION IS AS PER EIA-481.
- 4. TAPE AND REEL QUANTITY : TBA.
- 5. THE TAPE IS TREATED FOR ANTI-STATIC.

REVISED EC NO: S2011-0079 DRWN:SKANG CHKD:ATSEE APPR:MLONG 2010/07/30 2010/09/24 2010/09/24	DESCRIPTION REV	QUALITY SYMBOLS	GENERAL TOLERANCES (UNLESS SPECIFIED)		DIMENSION STYLE MM ONLY		SCALE NTS	DESIGN UNITS METRIC	THIRD ANGLE PROJECTION	
		$F_A=0$ $F_C=0$ $F_P=0$	mm	INCH	DRAWN BY YKOH	DATE 2005/03/16	TITLE SERIAL ATTACH SCSI RECEPTACLE, RIGHT-ANGLE SMT, 2.85MM HEIGHT			
			4 PLACES ± --- ± ---	3 PLACES ± --- ± ---	CHECKED BY DKOH	DATE 2005/03/23	MOLEX INCORPORATED			
			2 PLACES ± 0.20 ± ---	1 PLACE ± --- ± ---	APPROVED BY MLONG	DATE 2010/09/24	MATERIAL NO. SEE TABLE		DOCUMENT NO. SD-87975-101	SHEET NO. 5 OF 5
DRAFT WHERE APPLICABLE MUST REMAIN WITHIN DIMENSIONS			THIS DRAWING CONTAINS INFORMATION THAT IS PROPRIETARY TO MOLEX INCORPORATED AND SHOULD NOT BE USED WITHOUT WRITTEN PERMISSION							