

INTERCONNECTS

SERIES 416 • 2,54 GRID ELEVATED • DOUBLE ROW STRIPS

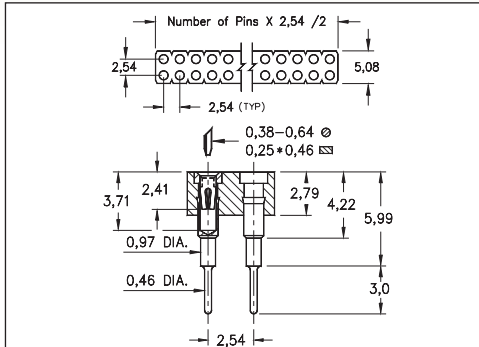

FIG. 1

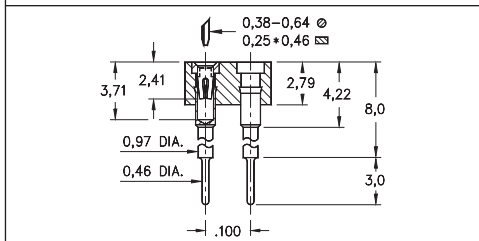

FIG. 2

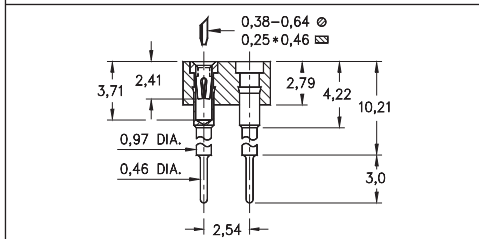

FIG. 3

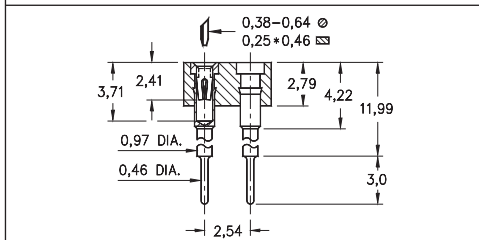

FIG. 4

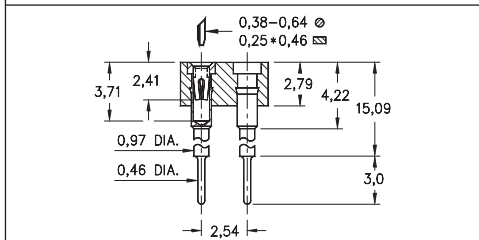

FIG. 5

- Elevated socket strips are available in 5 different heights:

416...006 uses pin # 0153-1
 416...003 uses pin # 0153-2
 416...007 uses pin # 0153-3
 416...008 uses pin # 0153-4
 416...001 uses pin # 0153-5
 See page 167 for details

- Hi-Rel, 4-finger BeCu #30 contact is rated at 3 amps. See page 253 for details

- Insulators are high temperature thermoplastic, suitable for all soldering operations

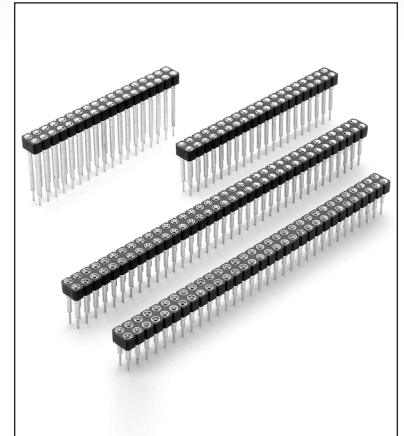



ORDERING INFORMATION

FIG. 1	Series 416...006 Standoff Height = 5,99
	416-XX-2--41-006000 Specify number of pins → 04-64
FIG. 2	Series 416...003 Standoff Height = 8,0
	416-XX-2--41-003000 Specify number of pins → 04-64
FIG. 3	Series 416...007 Standoff Height = 10,21
	416-XX-2--41-007000 Specify number of pins → 04-64
FIG. 4	Series 416...008 Standoff Height = 11,99
	416-XX-2--41-008000 Specify number of pins → 04-64
FIG. 5	Series 416...001 Standoff Height = 15,09
	416-XX-2--41-001000 Specify number of pins → 04-64



XX=Plating Code
See Below

For
Electrical, Mechanical
& Environmental Data,
See page 264

SPECIFY PLATING CODE XX=	91	93	41	43	
Sleeve (Pin) 	5,08µm Sn/Pb	5,08µm Sn/Pb	5,08µm Sn	5,08µm Sn	
Contact (Clip) 	0,25µm Au	0,76µm Au	0,25µm Au	0,76µm Au	

